

Uniden®

iGO CAM 600 **Accident CAM** **Vehicle Recorder**

For more exciting new products please visit our website:
Australia: www.uniden.com.au

OWNER'S MANUAL

Important Safety Instructions



NOTE

Uniden does not represent this product to be waterproof. Do not expose this product to Rain or Moisture.



NOTE

This product is intended for use in a motor vehicle. Don't install the device where it will block the driver's view of the road (including the mirrors!) or the deployment of the airbag.



NOTE

Keep your attention on the road! Don't try to operate or focus on any device while driving. If you have to concentrate on a device, pull off the road for a few minutes.



NOTE

Don't leave the device in direct sunlight for a long period of time or where the temperature could go above 60°C.



NOTE

Ensure that the camera lens is kept clean and there is nothing blocking the lens.

Contents

Important Safety Instructions	2
What Do I Do First?	4
Make Sure These Items Arrived in the Box	4
Controls & Indicators	5
How Do I Put It in My Car?	7
Attaching the Windshield Mount	7
Operation	8
Micro SD Card	8
Plug it in, Power On/Off	9
Video Mode	10
Photo Mode	12
Tool Setting	13
Playback Mode	14
Connecting to a PC	14
Important Information	15
Warranty	16

What Do I Do First?

Make Sure These Items Arrived in the Box



iGO CAM 600

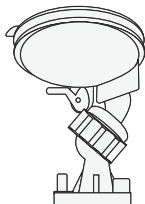

Windshield Mount



USB Cable

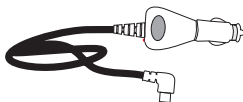

DC (CAR) Adaptor

- Owner's Manual

- If any item is missing or damaged, contact your place of purchase immediately. ***Never use damaged products!***
- Need help? Get answers at our website: ***www.uniden.com.au*** for Australian model.

Controls & Indicators

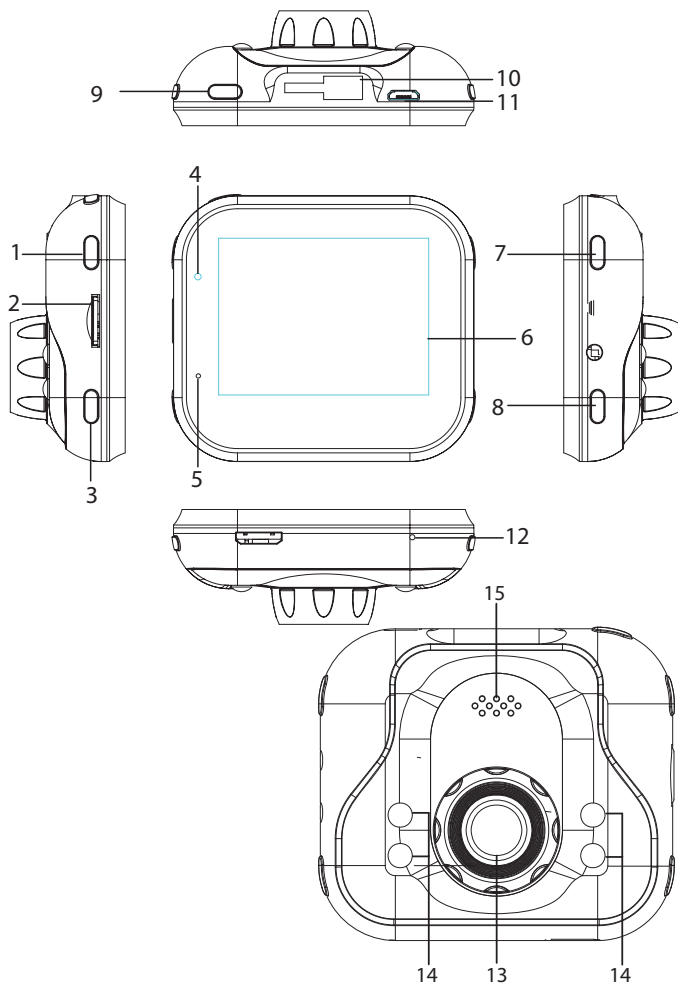

	Component	Description
1	UP	In Menu list, move the cursor, one line up.
2	Micro SD Card Slot	Use this slot to insert the micro SD card.
3	DOWN	In Menu list, move the cursor, one line down.
4	LED	<ul style="list-style-type: none"> Flashes blue when the unit is recording. Glow blue when powered on. Glow red when charging.
5	MIC	Records sound
6	LCD	LCD
7	OK	<ul style="list-style-type: none"> In Record mode, press to start or stop video recording. In Photo mode, press to take a photo. Press to confirm a selection in the Menu. Press to confirm a change in the settings.
8	MENU/ MODE	<ul style="list-style-type: none"> In Standby, open the menu. Press and hold to switch between various modes (video, photo, playback). While recording, press to manually lock the files.
9	POWER	Press and hold to either switch on or off the unit.
10	Bracket Slot	Fit the bracket hook of the windshield mount.
11	Micro USB Port	Connect to PC for data (SD card) transfer.
12	RESET	If the device fails to operate properly, try resetting the device. Press the reset button by using a fine pen.
13	Camera Lens	Lens
14	LEDs	Infrared night vision LEDs
15	Speaker	Speaker

How Do I Put It in My Car?

Attaching the Windshield Mount

1. Insert the bracket hook into the bracket slot provided on the top of the unit.

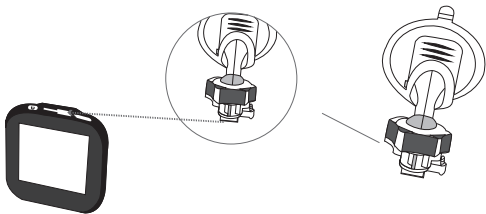

2. After inserting the hook, slide it down till it locks in position.

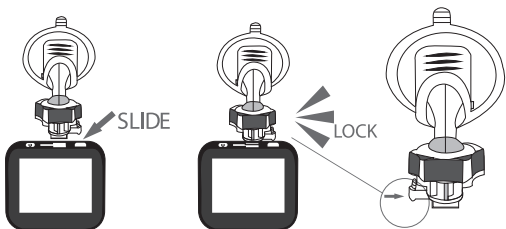

3. Press the suction cup flat against the windshield.

4. Push the suction lock up, until it snaps into place and tighten the locking collar to secure.

5. Gently pull on the mount to make sure it is secure.

It maybe a good idea to secure the power cord with cable clips so that it does not interfere while driving.



NOTE

Suction cups will not stick well on a curved/textured or wet surfaces.

Operation

Micro SD Card



NOTE

A compatible micro SD card has to be inserted before you start using the Recorder. Ensure that the unit is turned off before inserting or removing the SD card.

The unit can support micro SDHC cards (High Capacity SD) up to 32GB in capacity. A micro SDHC card of at least 4GB capacity and minimum speed of Class 10 is recommended.

Insert a formatted micro SD card gently in the slot at the side of the unit. To remove the card from the slot, press the edge of the SD card inwards for it to pop out and then pull it out of the slot.

It is important to format the micro SD card before using it, so as to avoid any damage to the files created on iGO CAM 600.

Uniden recommends using good quality micro SD cards.

Battery Alert

The unit has an in-built battery of 110mAh capacity.

The image given below indicates the battery level at different stages.



Empty



Low



Half full



Full



NOTE

Please ensure that the battery is fully charged before using it for the first time. To extend the battery life, charge the unit fully once every 2 months.

Plug it in, Power On/Off



NOTE

When connected to a car charger with power, the unit will power on automatically and start recording.

Connect the DC car adaptor to the power connector (USB/DC IN port) found on the device.

Connect the other end of the DC car adaptor to your car's cigarette lighter.

When connected to the car charger the unit will power on automatically and start recording. When the car's engine is turned off, the unit will automatically turn off in a few seconds.

At other times, press and hold the POWER button to turn it on or off.



NOTE

Only use the DC car adaptor that comes with your device. Any other adaptor might damage the device.

Video Mode



NOTE

To record a video, ensure that a valid micro SD card is inserted in the given slot.

Using the iGO CAM 600 you can record videos and take photos. To record videos, you need to ensure that the unit is in the Video mode.

Press and hold MENU/MODE button to switch between Video, Photo and Playback modes.

Recording

When connected to a car charger, the unit automatically goes into the video mode and starts recording. The  record icon will display on the screen.

A flashing red dot next to the record icon indicates that the unit is recording. To stop recording, press OK and the red dot disappears, indicating that the recording has stopped.

Protect the Current Recording

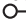
While recording, if you want to protect the current recordings, then press the MENU/MODE button, the  icon will appear on the screen. This indicates that those recordings have been locked and will not be overwritten by new video clips.

Menu Settings



NOTE

Please note, you cannot access MENU in the video mode, when the unit is recording. To access the Menu settings, you will need to stop recording by pressing OK.

Press MENU/MODE to open the Menu Settings. The UP/DOWN keys can be used to scan through the options, under each menu setting. Press OK to select the required option.

Press MENU/MODE to exit the Menu Settings.

Item	Description
Resolution	Set the video resolution.
Loop Recording	Use this option to set the length of each video clip. If you choose the option 'Off' then the recorder will not loop record and the files will not be overwritten on the micro SD card.
WDR	Helps to record finer details.
Exposure	Set the brightness sensitivity.
Motion Detection	Enable this setting to allow the recorder to start recording when it detects movement.
Record Audio	Turn on or off to include sound in the recordings.
Date Stamp	Displays or hides the date and time in the recordings.
G-Sensor	Use this setting to activate the Collision Detection sensitivity. In the event of sudden movement, such as a crash or an overturn, the G-sensor alerts the unit to save and lock the current recording file.

Photo Mode

- Press and hold the MENU/MODE button to switch to the photo mode, the  icon will display on the top left corner of the screen.
- Now, press the OK button to take a photo.

In the Photo mode, press MENU/MODE button to open the Menu Settings. The UP/DOWN keys can be used to scan through the options, under each menu setting. Press OK to select the required option.

Press MENU/MODE to exit the Menu Settings.



Item	Description
Capture Mode	Use the options to set the time gap for capturing an image.
Resolution	Set the photo resolution.
Sequence	The camera goes into a continuous shooting mode when this option is activated.
Quality	Choose between the options to define the quality of the images you want to capture.
Sharpness	Choose between the options to define the clarity in detail of the images you want to capture.
White Balance	Using this setting, establish the condition to capture an image, from the options available.
Colour	Choose between the options to set a background colour for the images.
ISO	Choose the options under this setting, to increase or decrease the sensitivity of the camera towards light.
Exposure	The EV setting allows you to darken or brighten your image.
Anti-Shaking	When this setting is activated, the camera shake is effectively reduced, helping you capture a better quality image.
Date Stamp	Use to display or hide the date and time on the image files.

Tool Setting

In any of the modes (video, photo or playback), press the MENU/MODE button twice to open the tool setting.

Item	Description
Date/Time	Set the date and time.
Key Tone	Have the buttons sound a tone when you press them.
Language	Set the language.
AV Out	The default setting is PAL.
Frequency	Set the frequency.
Screen saver	Use the option to turn off LCD when the unit has been idle.
IR LED	Set to turn on/off the night vision LEDs.
Format	Use to format the SD card
Default Setting	Use this option to change all the settings back to the default factory settings.
Version	Firmware version.

Playback Mode

- Press and hold the MENU/MODE button to switch to the playback mode, the  or  playback icons will display on the top left corner of the screen.
- Now, press the OK button to either view the latest image captured or the latest video clip. Press the UP and DOWN keys to scan through the various recordings or images.

Press MENU/MODE to open the Menu Settings. The UP/DOWN keys can be used to scan through the options, under each menu setting. Press OK to select the required option.

Press MENU/MODE to exit the Menu Settings.

Item	Description
Delete	Use to delete current file or all files.
Protect	Use to lock/unlock files.
Slide Show	Set the time for the images/videos to be displayed on the screen.

Connecting to a PC (Optional)

The iGO CAM 600 can be connected to a PC. Plug the USB cable into the USB port.

When the unit is connected to a PC, two options are displayed on the unit's screen;

- Mass Storage
- PC Camera

Select Mass Storage to manage and view the SD card contents on the PC.

Open the contents of the SD card on the PC, to view the DCIM folder. Double click on the DCIM folder to open the more folders (sorted according to dates).

Double click on any of those folders to view images/recordings.

Important Information

Solving Problems

Listed below are some of the problems and the possible solutions. If you still need help, visit our website, listed on the front cover.

General Problems	Possible Solutions
The unit cannot take photos or record videos The unit stops automatically when recording	<ul style="list-style-type: none">• Ensure that the SD card is formatted properly and inserted correctly.• Use the recommended type of SD card (4GB Class 10)
Video is unclear	Ensure that there are no fingerprints or dirt on the lens. Ensure that the lens is always kept clean.
Dark images while recording water/sky	Adjust the Exposure setting.
Colour of the images is not good	Set the 'White Balance' setting to automatic.
Cross-stripe interference in an image	This is due to the light frequency. Change the light frequency depending on the local power supply.
The unit crashes	Press and hold the 'Reset' button, with a pin, to reset the unit.

Warranty

UNIDEN iGO CAM 600

IMPORTANT: Satisfactory evidence of the original purchase is required for warranty service

Please refer to our Uniden website for any details or warranty durations offered in addition to those contained below.

Warrantor: The warrantor is Uniden Australia Pty Limited ABN 58 001 865 498 (“Uniden Aust”).

Terms of Warranty: Uniden Aust warrants to the original retail purchaser only that the iGO CAM 600 (“the Product”), will be free from defects in materials and craftsmanship for the duration of the warranty period, subject to the limitations and exclusions set out below.

Warranty period: This warranty to the original retail purchaser is only valid in the original country of purchase for a Product first purchased either in Australia or New Zealand and will expire, as indicated below, from the date of original retail sale.

Product	1 Year
Accessories	90 Days

If a warranty claim is made, this warranty will not apply if the Product is found by Uniden to be:

- (A) Damaged or not maintained in a reasonable manner or as recommended in the relevant Uniden Owner’s Manual;
- (B) Modified, altered or used as part of any conversion kits, subassemblies or any configurations not sold by Uniden Aust;
- (C) Improperly installed contrary to instructions contained in the relevant Owner’s Manual
- (D) Repaired by someone other than an authorized Uniden Repair Agent in relation to a defect or malfunction covered by this warranty; or
- (E) Used in conjunction with any equipment, parts or a system not manufactured by Uniden.

Parts Covered: This warranty covers the Product and included accessories.

User-generated Data: This warranty does not cover any claimed loss of or damage to user-generated data (including but without limitation phone numbers, addresses and images) that may be stored on your Product.

Statement of Remedy: If the Product is found not to conform to this warranty as stated above, the Warrantor, at its discretion, will either repair the defect or replace the Product without any charge for parts or service. This warranty does not include any reimbursement or payment of any consequential damages claimed to arise from a Product's failure to comply with the warranty.

Our goods come with guarantees that cannot be excluded under the Australian Consumer Law. You are entitled to a replacement or refund for a major failure and for compensation for any other reasonably foreseeable loss or damage. You are also entitled to have the goods repaired or replaced if the goods fail to be of acceptable quality and the failure does not amount to a major failure.

This warranty is in addition to and sits alongside your rights under either the COMPETITION AND CONSUMER ACT 2010 (Australia) or the CONSUMER GUARANTEES ACT (New Zealand) as the case may be, none of which can be excluded.

Procedure for obtaining warranty service: Depending on the country in which the Product was first purchased, if you believe that your Product does not conform with this warranty, you should deliver the Product, together with satisfactory evidence of your original purchase (such as a legible copy of the sales docket) to Uniden. Please refer to the website for address details. You should contact Uniden regarding any compensation that may be payable for your expenses incurred in making a warranty claim. Prior to delivery, we recommend that you make a backup copy of any phone numbers, images or other data stored on your Product, in case it is lost or damaged during warranty service.

UNIDEN AUSTRALIA PTY LTD

Phone: 1300 366 895

Email: custservice@uniden.com.au

Uniden®

© 2013 Uniden Australia Pty Limited.
Printed in China